

PERFIL LONGITUDINAL 01

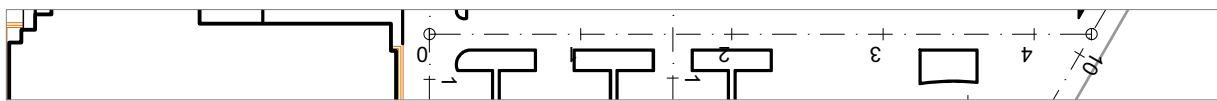

PERFIL LONGITUDINAL 02

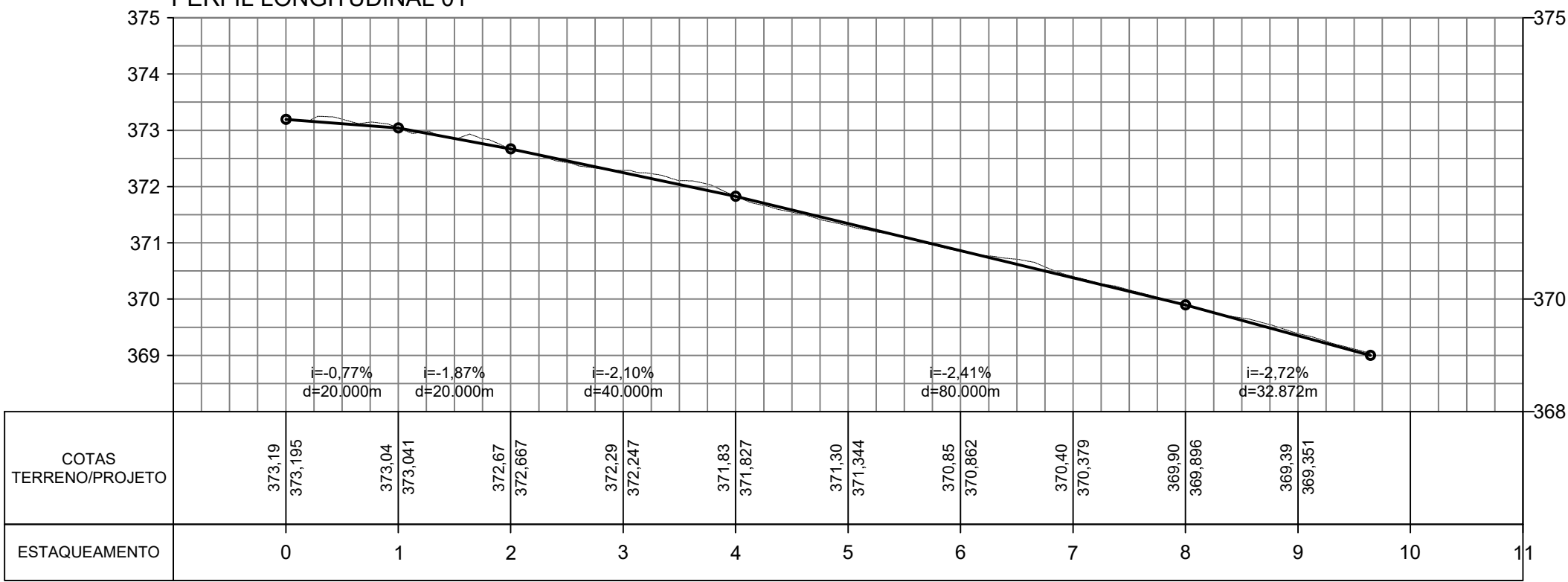
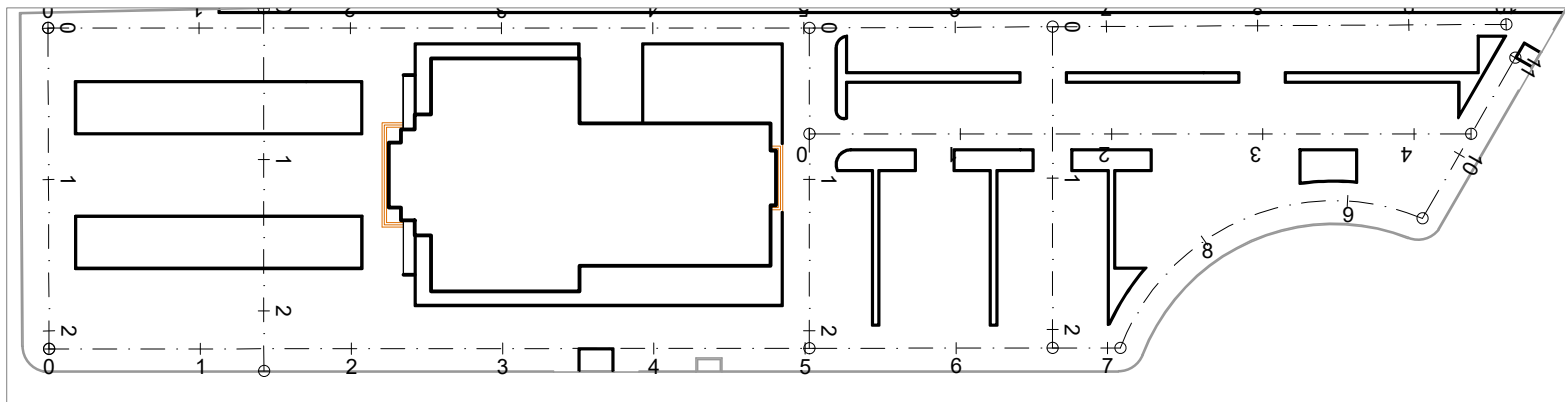
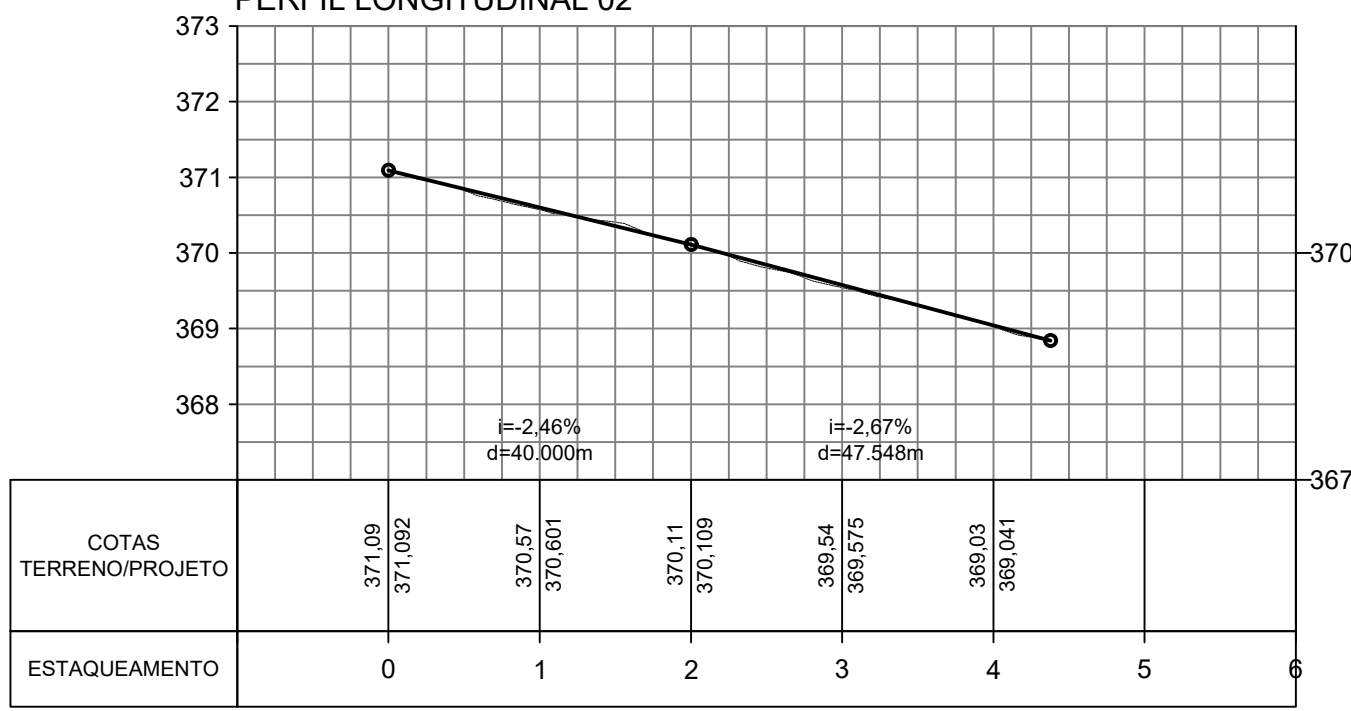

PERFIL LONGITUDINAL 03

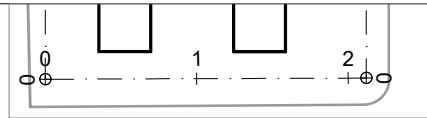
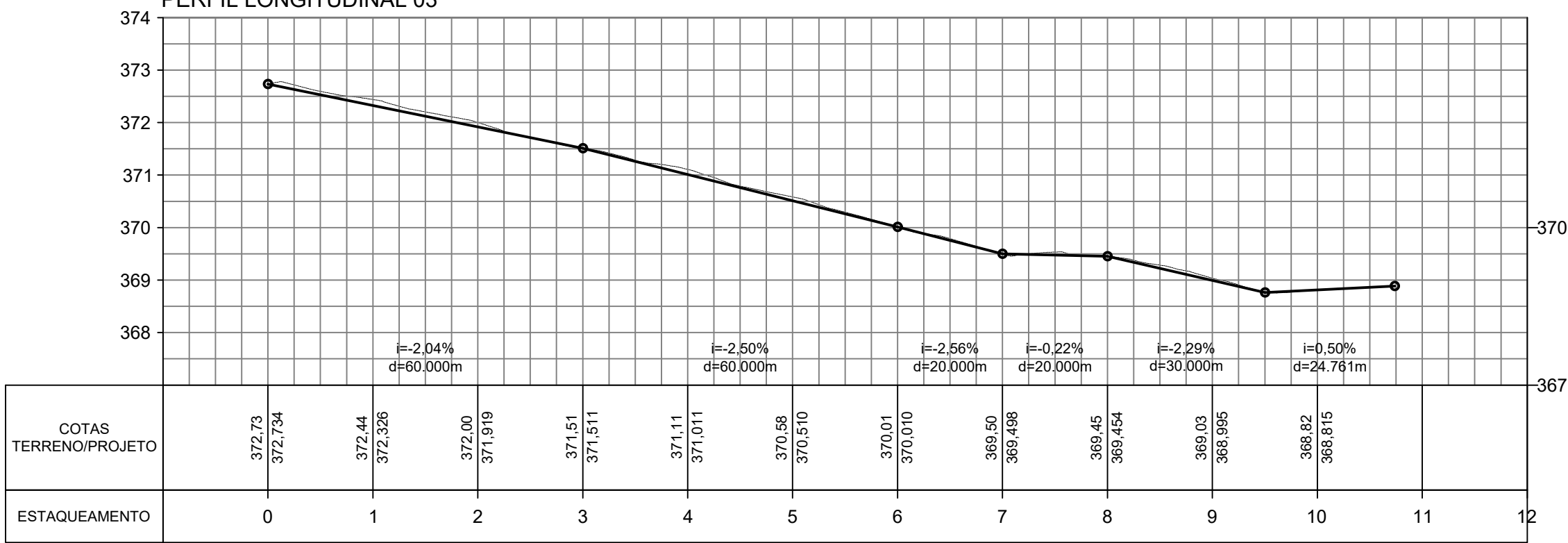

PERFIL TRANSVERSAL 01

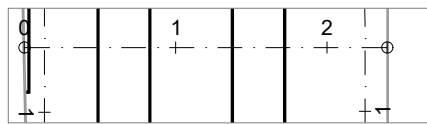
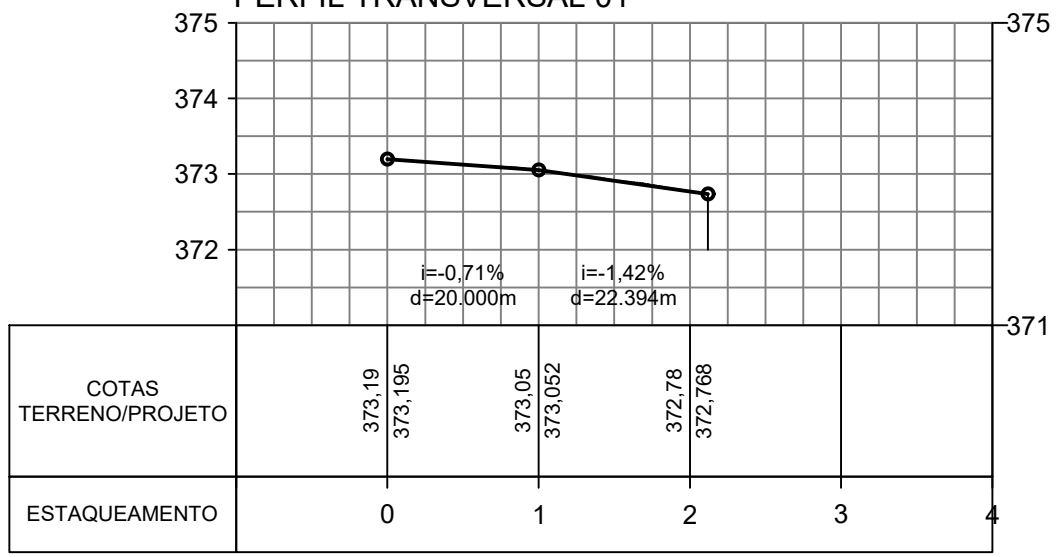

PERFIL TRANSVERSAL 02

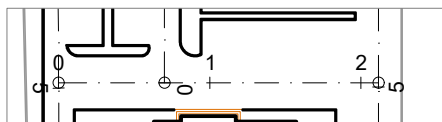
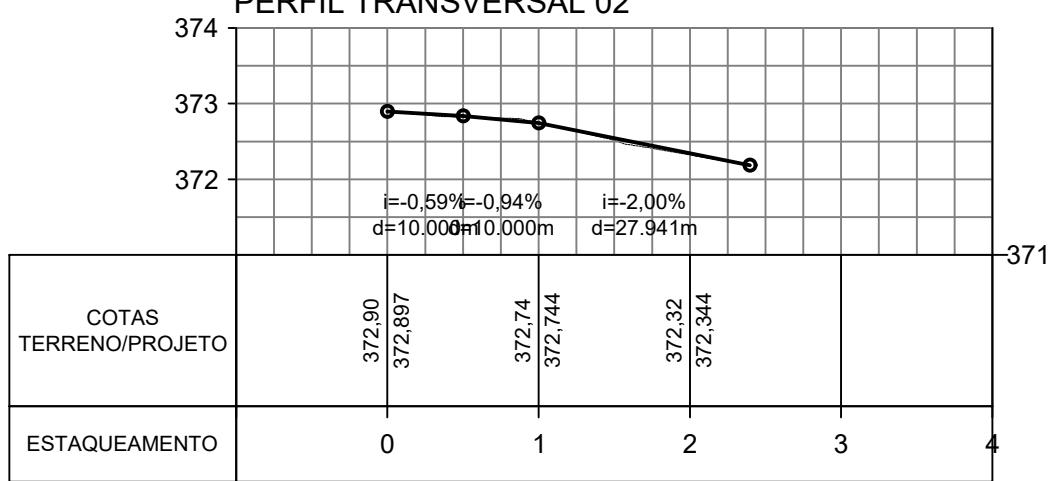

PERFIL TRANSVERSAL 03

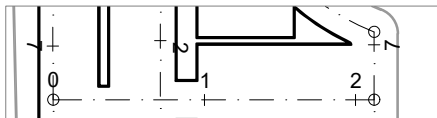
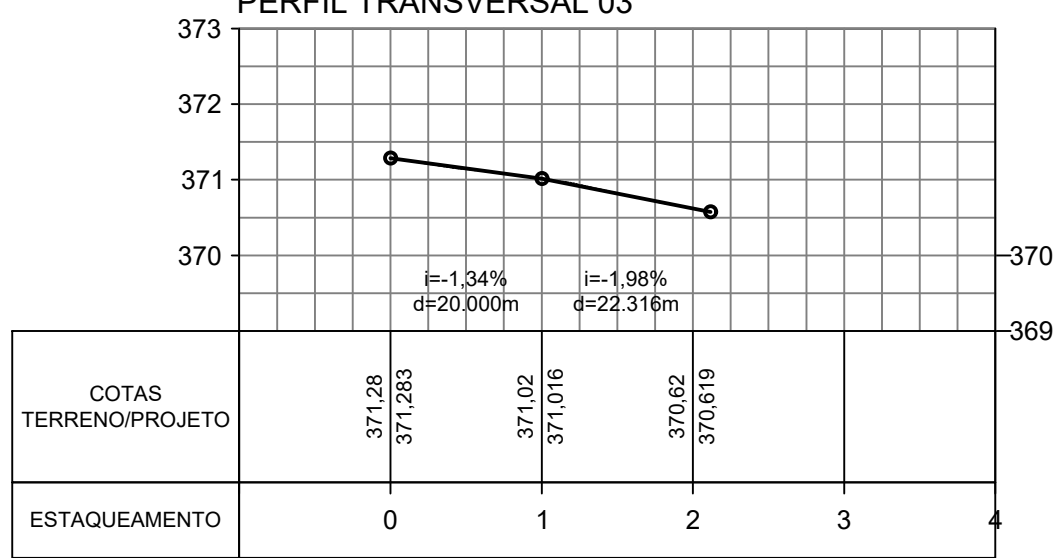

PERFIL TRANSVERSAL 04

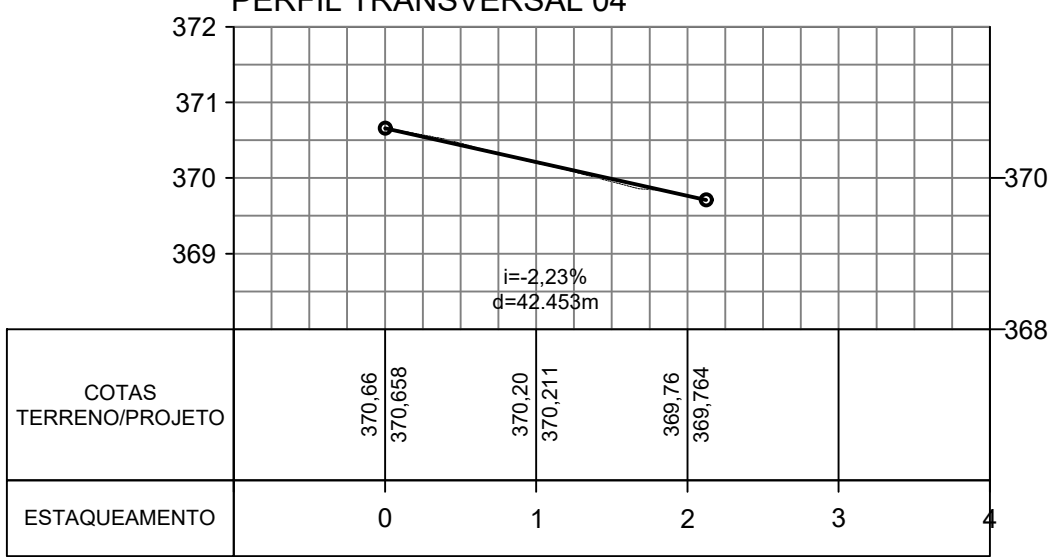

## Prefeitura Municipal de Sorriso

ESTADO DE MATO GROSSO  
Gestão 2017/2020

OBRA:

COMPLEXO DA CIDADANIA

PROJETO:

PAVIMENTAÇÃO / DRENAGEM / SINALIZAÇÃO

DETALHES:

PERFIS DE TERRAPLENAGEM

### ENDEREÇO:

AVENIDA PERIMETRAL SUDOESTE ESQUINA COM RUA LA PAZ -  
ZONA DE INTERESSE INSTITUCIONAL (ZII) + (ZCT3) - ÁREA 03  
MATRÍCULA Nº 25610

SORRISO-MT

RESPONSÁVEL TÉCNICO:

Silvia Romfim  
Engenheira Civil CREA - MT 026160

VISTO:

Ednilson de Lima Oliveira  
Secretario da cidade

ÁREAS:

ÁREA DO LOTE 270m²  
ÁREA PARA CALCULO ESTRUTURAL 218,78m²

PROPRIETÁRIO:

Prefeitura Municipal de Sorriso  
CNPJ: 03.239.076/0001-62

DATA:

Novembro / 2021

ESCALA:

INDICADAS

DESENHO:

-

ARQUIVO:

REV.001

FOLHA:

01/07